

# IBM Power System AC922 (8335-GTG) Quick Install Guide



## IBM® Power® System AC922 (8335-GTG) Quick Install Guide

Read all precautions and instructions before you start working on the system and its parts.

Use normal electrostatic discharge (ESD) procedures when working on the system and parts. IBM recommends wearing gloves and an ESD wrist strap to avoid possible damage to the equipment.

The information about the 8335-GTG system is available online in the IBM Knowledge Center.

8335-GTG: <http://www.ibm.com/support/knowledgecenter/8335-GTG>

### 8335-GTG parts

Use this information to find the field-replaceable unit (FRU) part number.

#### Rack final assembly

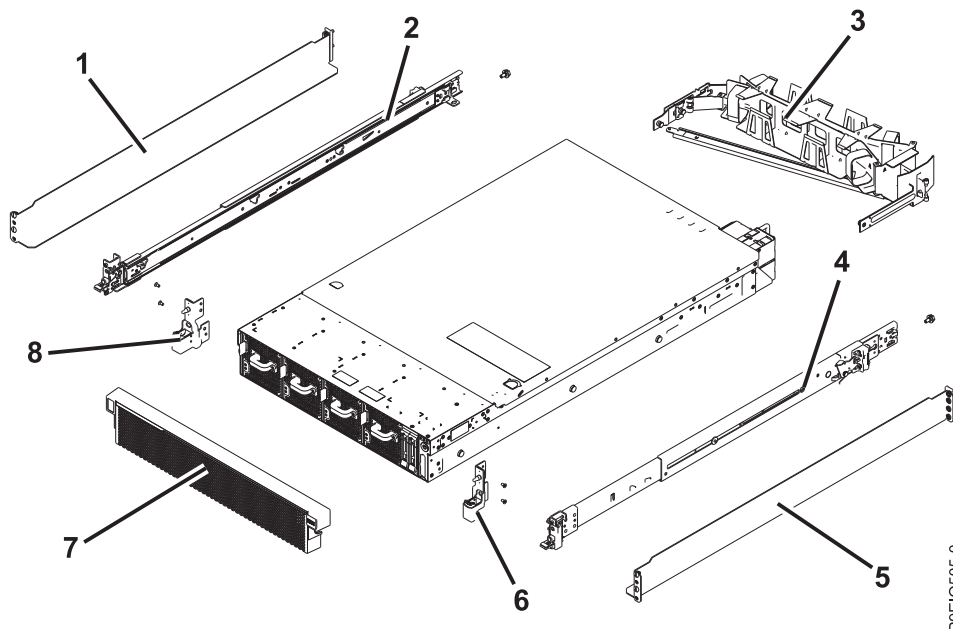

Figure 1. Rack final assembly

Table 1. Rack final assembly part numbers

Index number	Part number	Units per assembly	Description
1	45W8836	1	Fixed rail kit - contains left and right fixed rails and attaching screws

Table 1. Rack final assembly part numbers (continued)

Index number	Part number	Units per assembly	Description
2	00E4260	1	Slide rail kit - contains left and right slide rails and attaching screws
3	74Y9063	1	Cable management arm assembly <b>Note:</b> This part can only be used with a slide rail kit.
4	45W8836	1	Fixed rail kit - contains left and right fixed rails and attaching screws
5	00E4260	1	Slide rail kit - contains left and right slide rails and attaching screws
6	00E7329	1	Electronic Industries Association (EIA) bracket (right side)
7	02CL350	1	Bezel
8	00E7328	1	EIA bracket (left side)

## System parts (8335-GTG air-cooled)

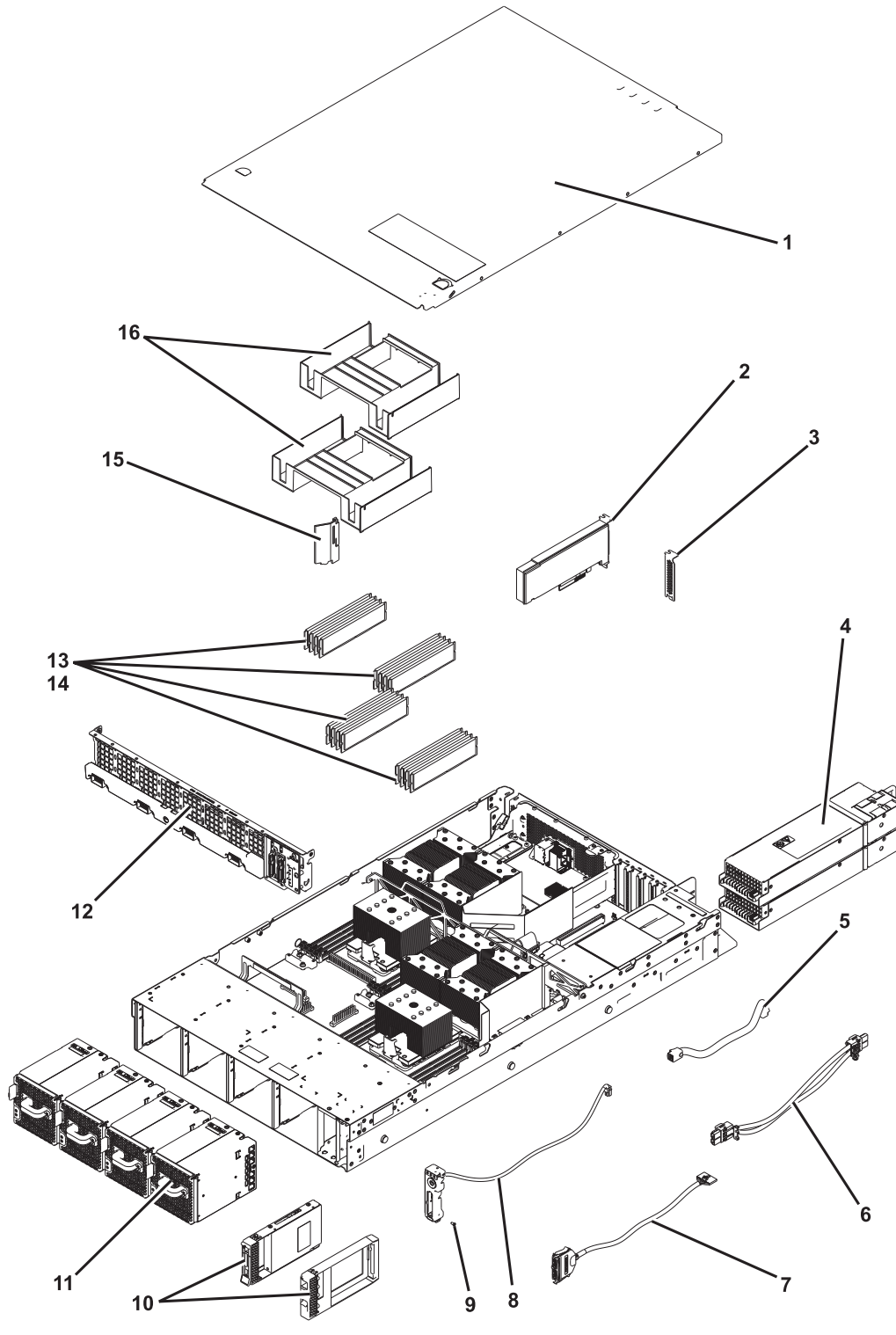

Figure 2. System parts (8335-GTG air-cooled )

Table 2. System parts (8335-GTG air-cooled)

Index number	Part number	Units per assembly	Description
1			Top access cover assembly
2		1-4	PCI adapters
3	46K5109	0-3	PCI filler
4	02CL336	2	Power supply
5	00E4768	1	Disk and fan signal cable
6	00E4766	1	Fan power cable
7	00E4765	1	Front USB cable with connector
8	01EM382	1	Power switch and power switch cable
9		1	Screw
10	00E4252	0-2	Drive filler
10	00LY460	0-2	960 GB solid-state drive
10	00LY461	0-2	1.92 TB solid-state drive
10	00LY462	0-2	3.84 TB solid-state drive
11	01EM065	4	Fan
12	01NN923	1	Disk drive and fan card
13	78P4191	16	8 GB, 2.133 MHz ISDIMM
14	78P4192	16	16 GB, 2.133 MHz ISDIMM
14	78P4198	16	32 GB, 2.133 MHz ISDIMM
14	78P4199	16	64 GB, 2.133 MHz ISDIMM
14	78P4200	16	128 GB, 2.133 MHz ISDIMM
14	01G4204	0-15	DIMM filler
15	01EM008	1	Power supply air baffle (small)
16	01EM004	2	System processor module air baffles

### Additional system parts (8335-GTG air-cooled system)

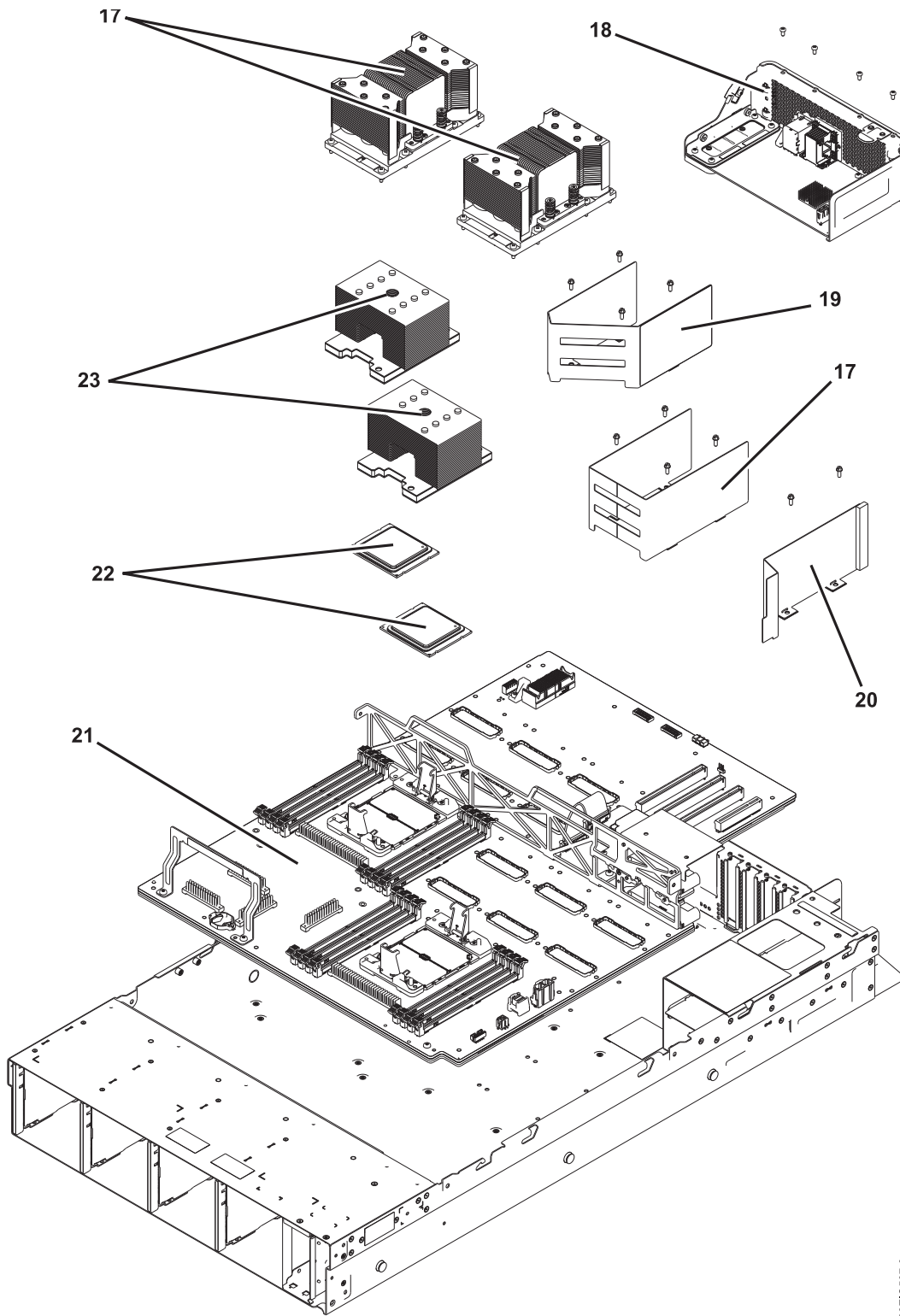

Figure 3. Additional system parts (8335-GTG air-cooled system)

PSRFD0507-0

Table 3. Additional system parts (8335-GTG air-cooled system)

Index number	Part number	Units per assembly	Description
17	01KL843	0-4	GPU kit (includes GPU card, heat sink, and thermal interface material (TIM))
17	01EM071	0-4	GPU filler
18	01DH007	1	Baseboard management controller (BMC) card
19	01EM009	2-4	GPU air baffle
20	01EM010	1	Power supply air baffle (large)
21	01EM305	1	System backplane kit (includes system backplane, module removal tool, 4 mm hex key, magnetic screwdriver, air pump, and lid removal tool)
22	01EM316	2	16 core 2.250 GHz system processor module kit (includes system processor module, processor tray, 4mm hex driver, module replacement tool, and air pump)
22	01EM320	2	20 core 2.250 GHz system processor module kit (includes system processor module, processor tray, 4mm hex driver, module replacement tool, and air pump)
23	01EM317	2	System processor heat sink kit (includes heat sink and TIM)
23	01EM317	2	System processor heat sink kit (includes heat sink and TIM)

## Miscellaneous parts

Table 4. Miscellaneous system parts

Description	Part number	Units per assembly
Time-of-day battery	00RY543	1
Baffle screw kit <b>Note:</b> The screw kit includes one screw for each of the power supply air baffles and one screw for the empty GPU slot. There are a total number of three screws in this kit.	01EM312	1

## Rear ports

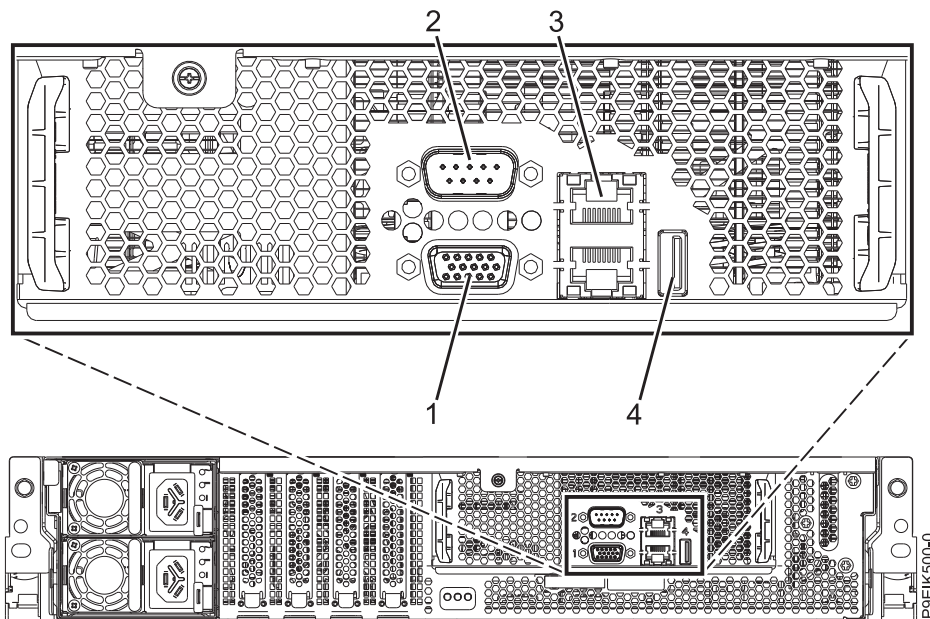

Figure 4. Rear view of the system with ports displayed

Table 5. Port descriptions

Identifier	Description
1	Video Graphics Array (VGA)
2	Intelligent Platform Management Interface (IPMI) serial
3	Ethernet. Use the top Ethernet port for the BMC/IPMI interface (as PHY0). Use the bottom Ethernet port for any direct OS usage (as PHY1).
4	USB 3.0

## Installing and removing IBM Power System AC922 (8335-GTG) parts

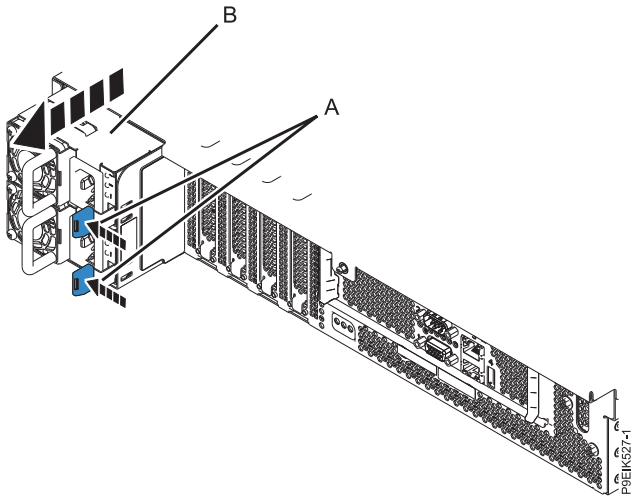

Figure 5. Removing the power supplies from the system

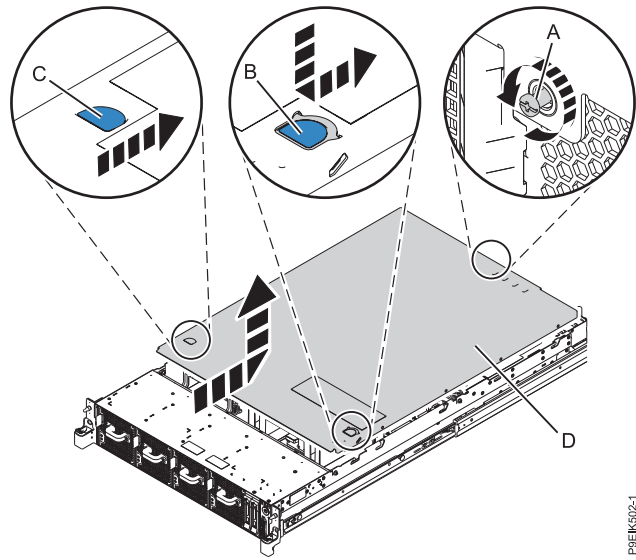

Figure 6. Removing the cover

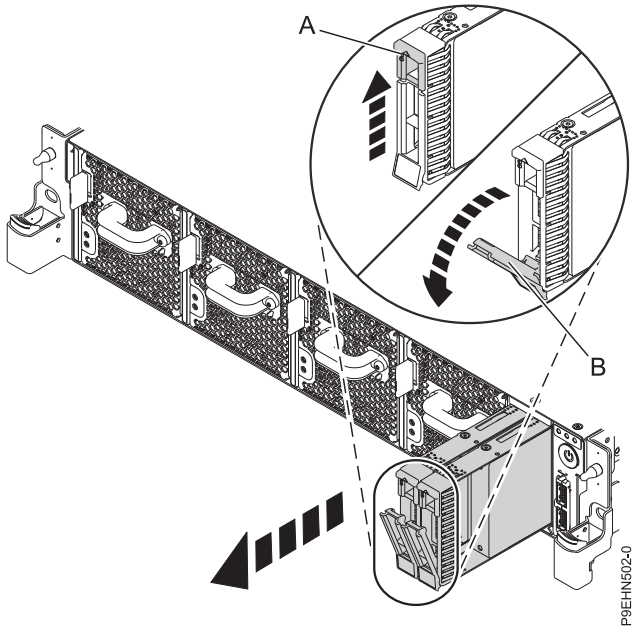

Figure 7. Disk drive lock detail

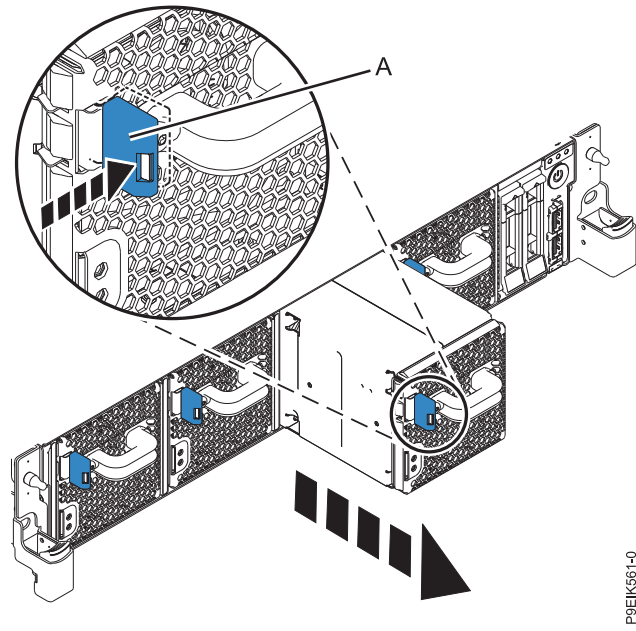

Figure 8. Removing a fan from the system



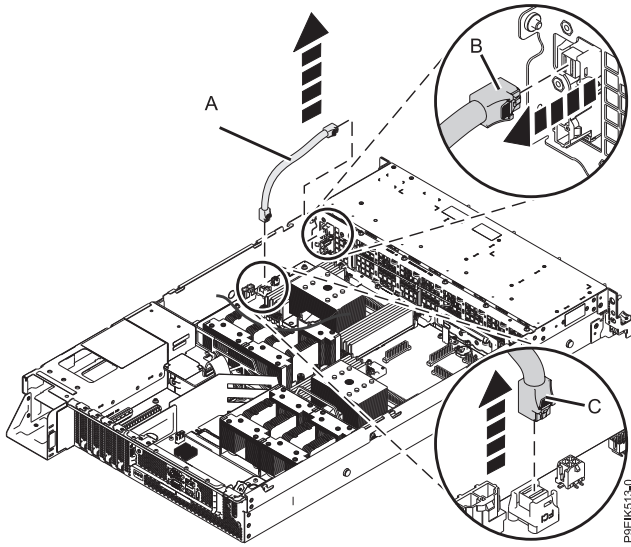

Figure 9. Removing the disk and fan signal cable

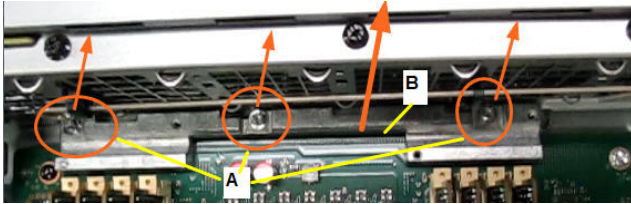

Figure 11. Removing the front holder

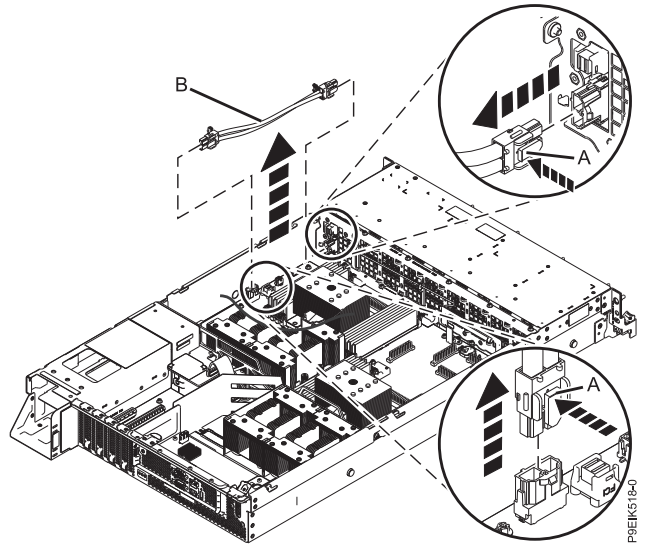

Figure 10. Removing the fan power cable from the system

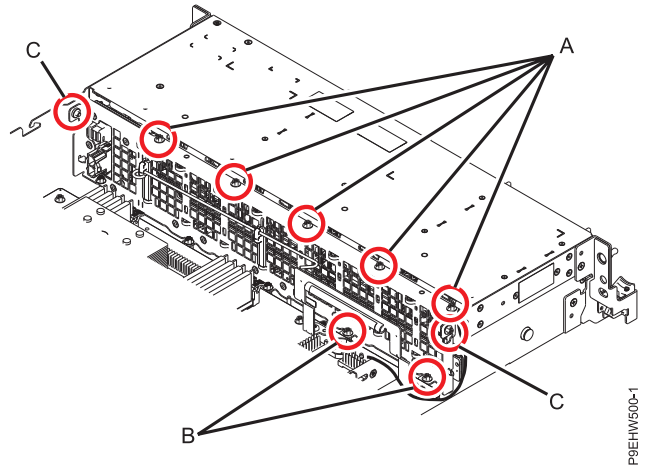
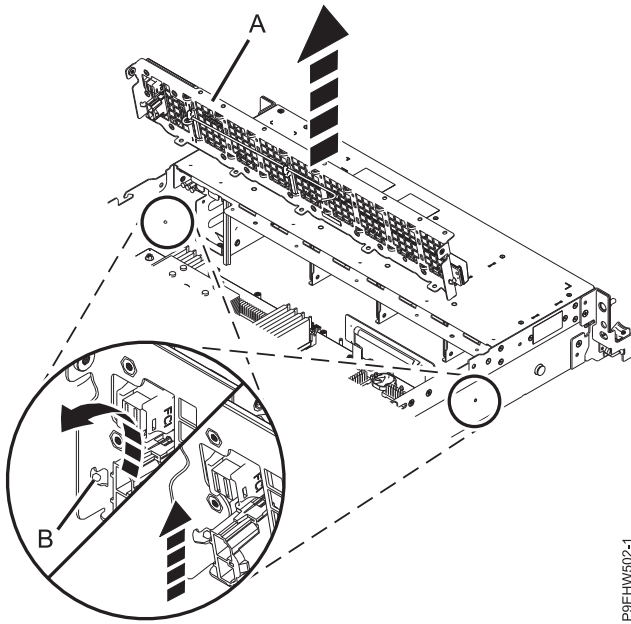
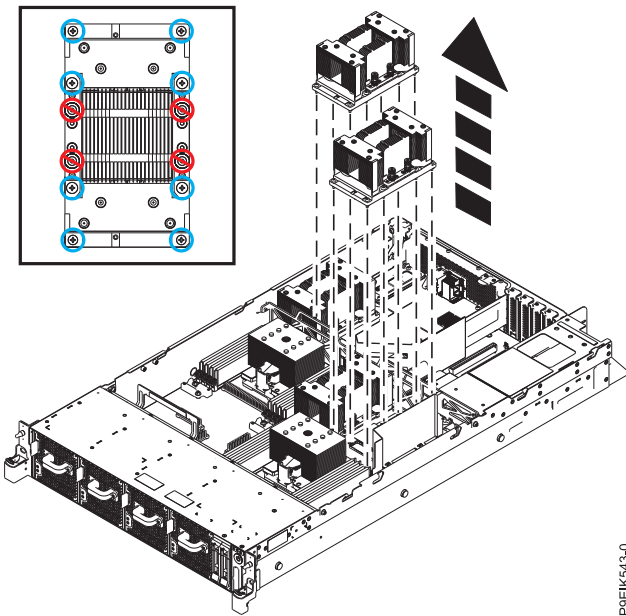

Figure 12. Screw locations for the disk drive and fan card



P9EHW502-1

Figure 13. Removing the disk drive and fan card



P9EIK543-0

Figure 14. Remove eight GPU screws per GPU; do not loosen the four spring-loaded screws

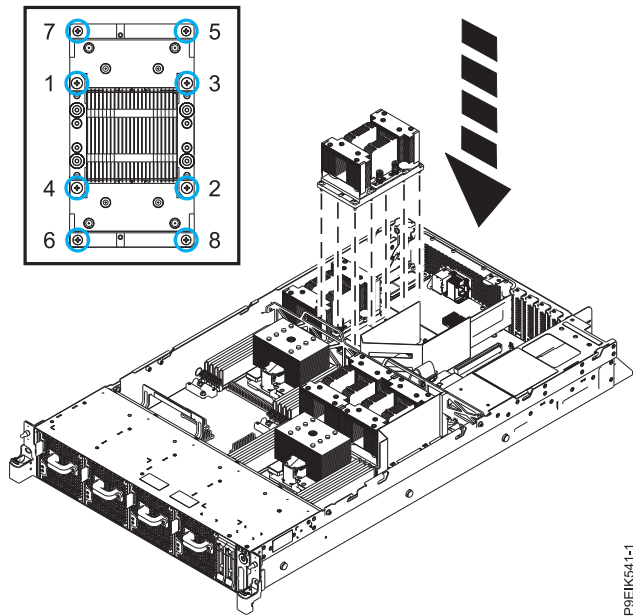

P9EIK541-1

Figure 15. Replacing the GPU and heat sink into system backplane

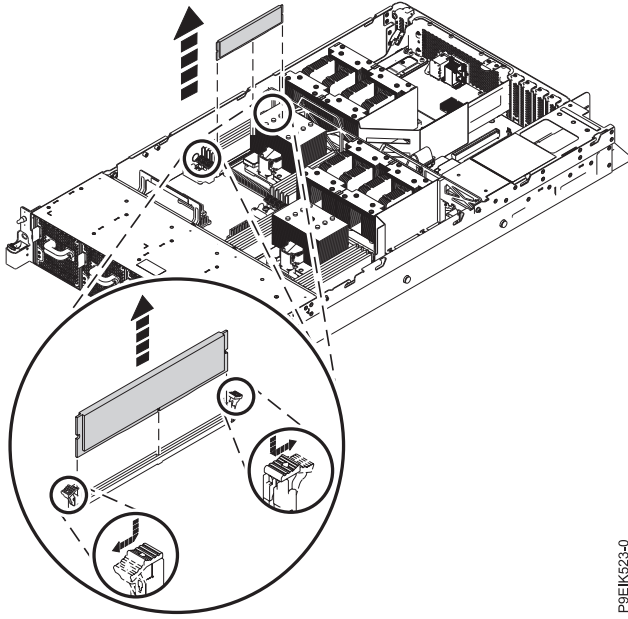
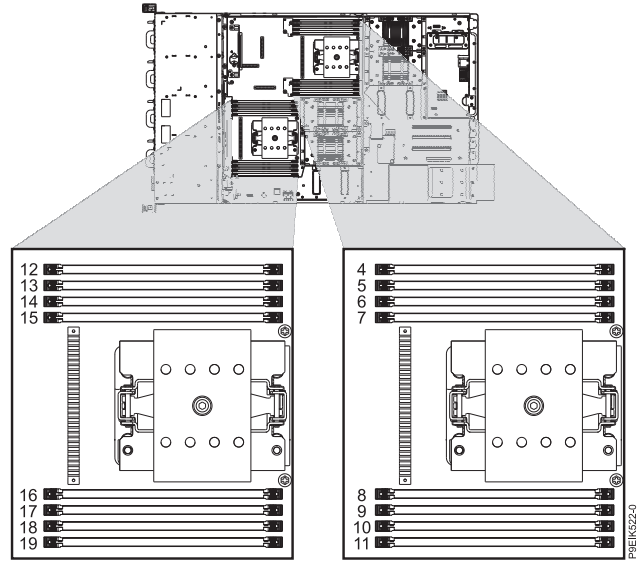

Figure 16. Removing a memory module



P9EIK523-0

Figure 17. Location of the memory modules, locations 4 through 19

P9EIK522-0

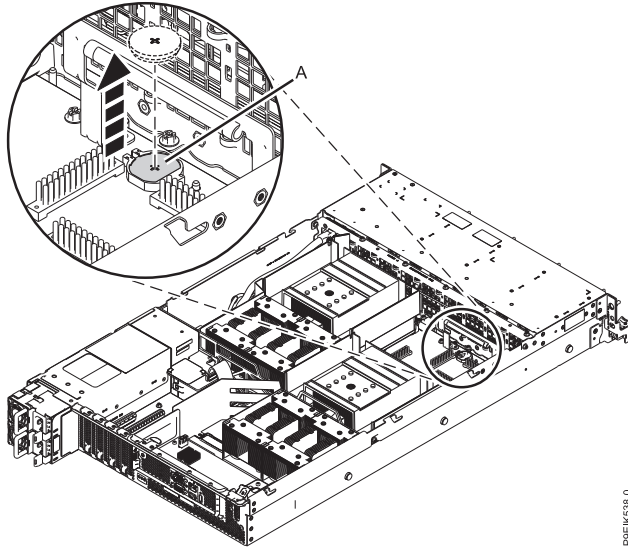

P9EIK38-0

Figure 18. Removing the time-of-day battery from the system backplane

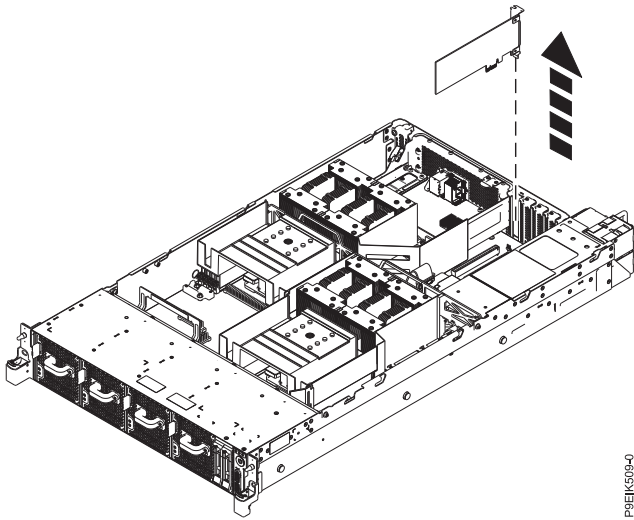

Figure 19. Removing a PCIe adapter

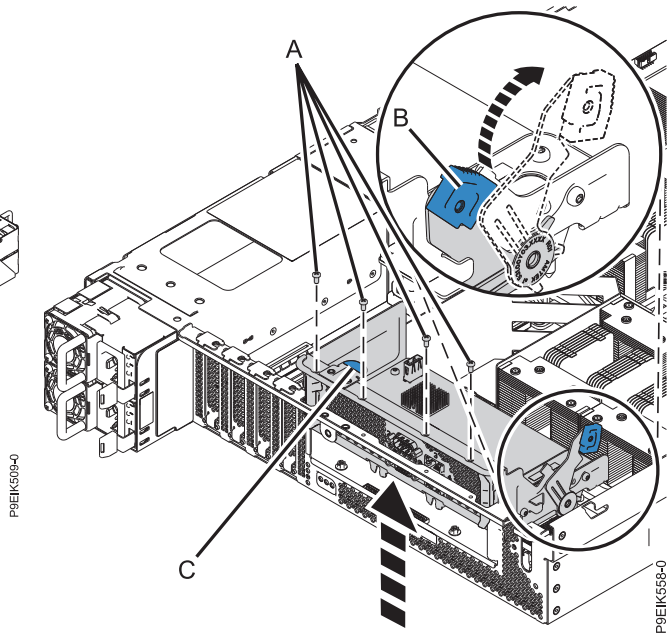

Figure 20. Removing BMC card

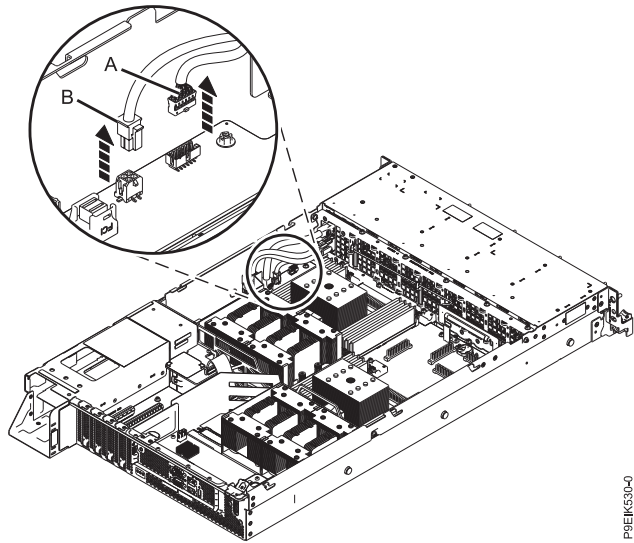

Figure 21. Removing the USB cable and the power switch and cable from the system backplane and the disk drive and fan card

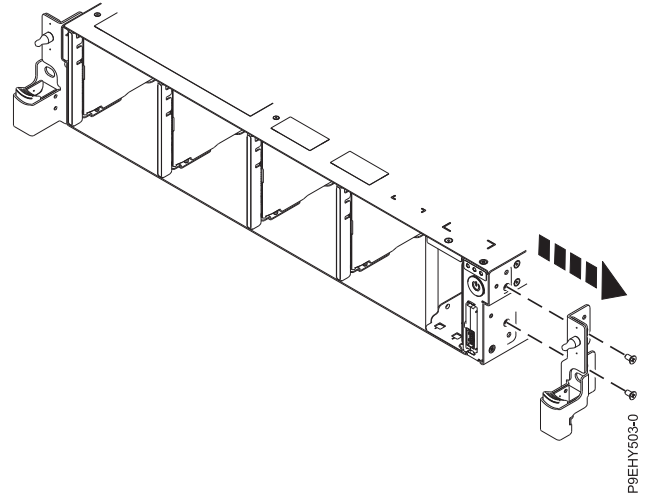

Figure 22. Removing the rack installation support

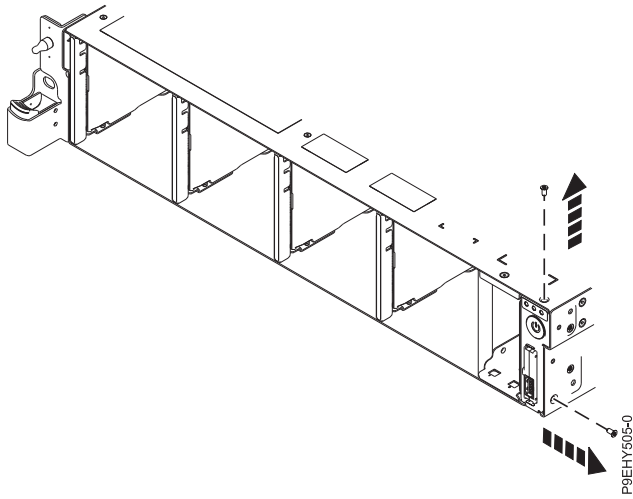

Figure 23. Remove the top and side screws

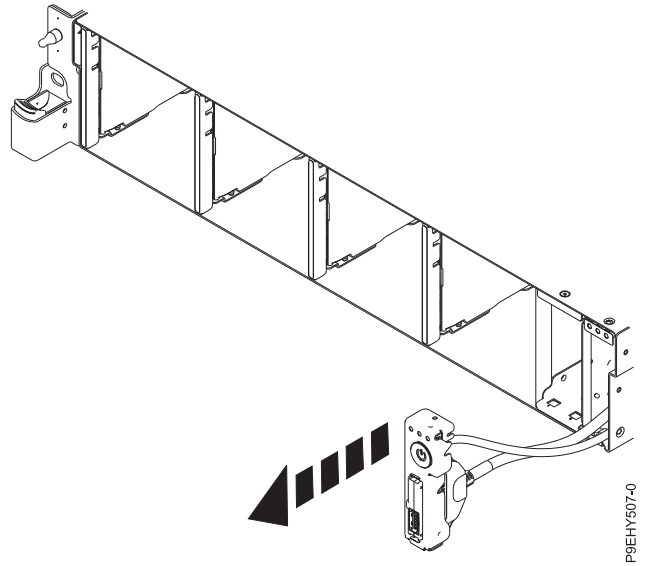

Figure 24. Pull out the power switch and cable

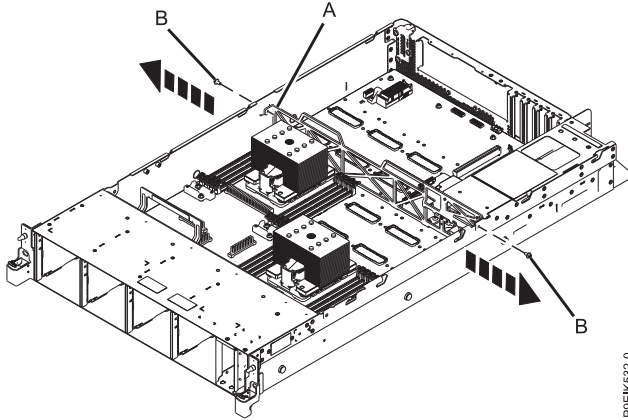

Figure 25. Remove the middle support side screws

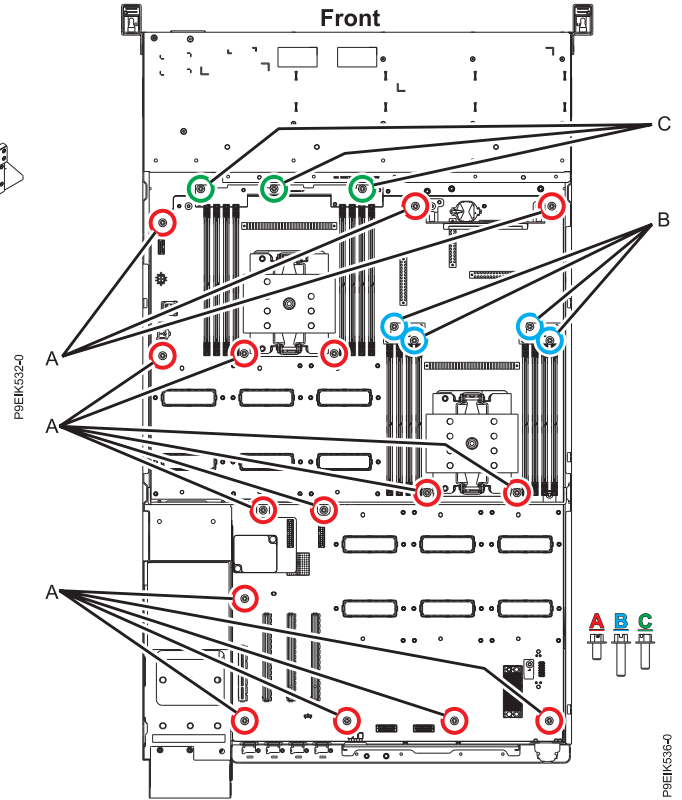
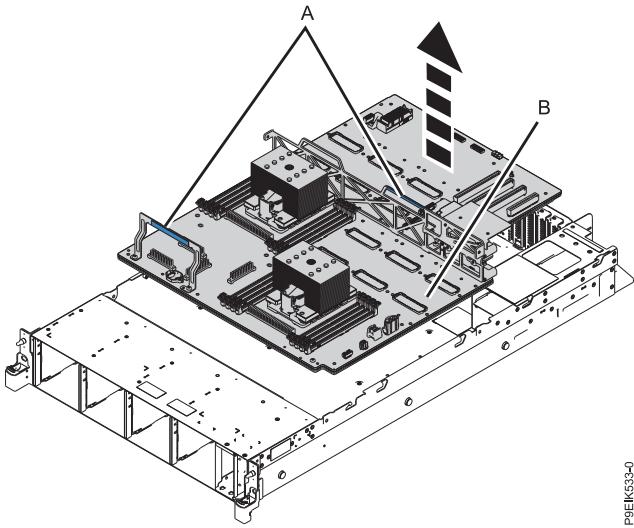
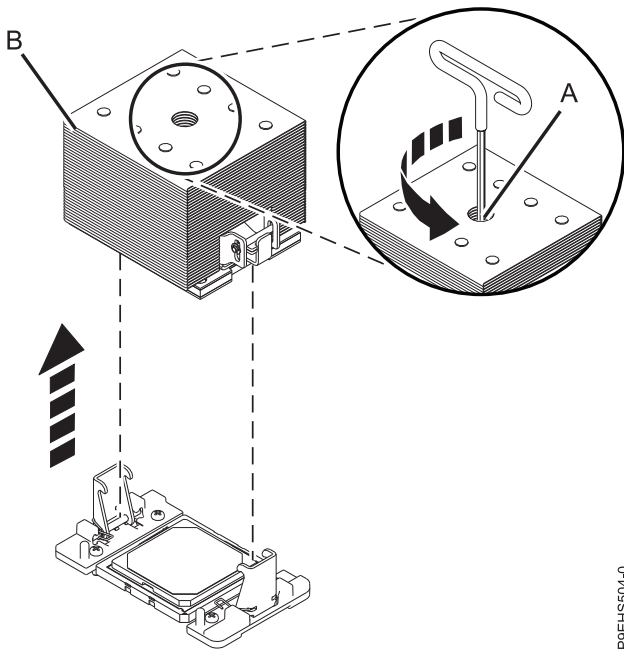

Figure 26. System backplane screw locations



P9EHK533-0

Figure 27. Lifting out the system backplane



P9EHS504-0

Figure 28. Removing the heat sink

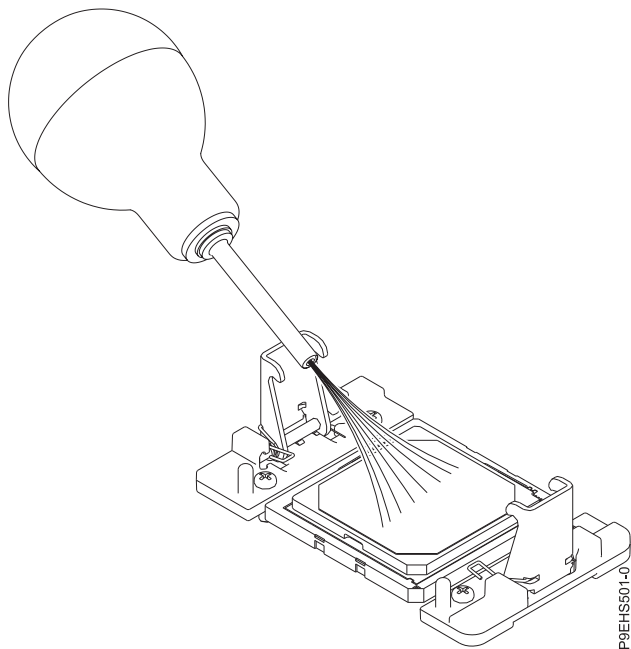

P9EHS011-0

Figure 29. Removing dust and debris from the system processor module area

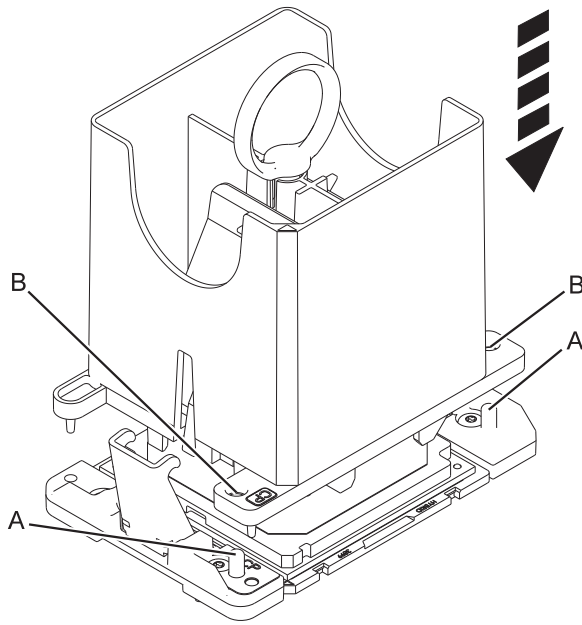

Figure 30. Lowering the removal tool onto the system processor module

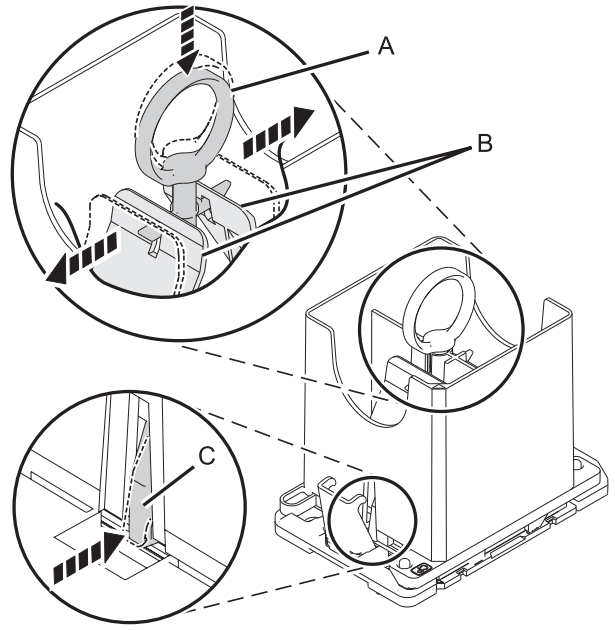

Figure 31. Locking the system processor module into the tool

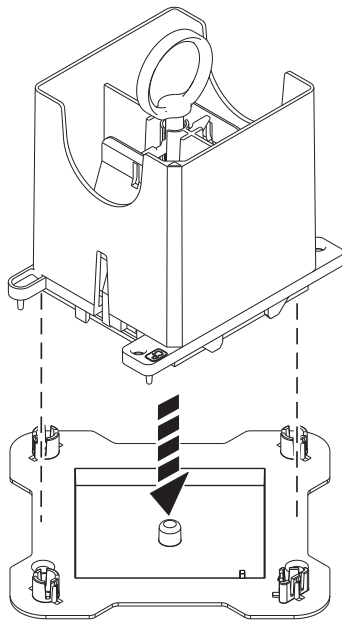

Figure 32. Placing the tool at an angle on the top cover of the packaging

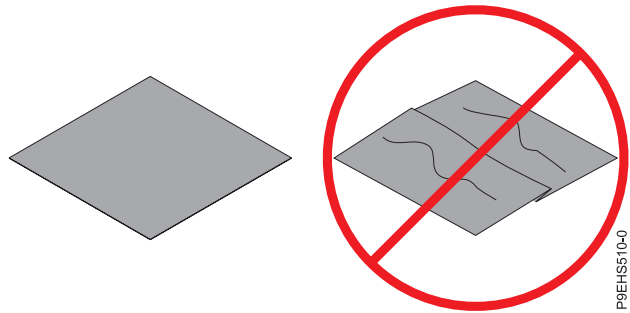

Figure 33. Inspecting the thermal interface material

P9EIK581-0

P9EHS510-0

P9EIK586-0

If the thermal interface material is damaged, replace it.

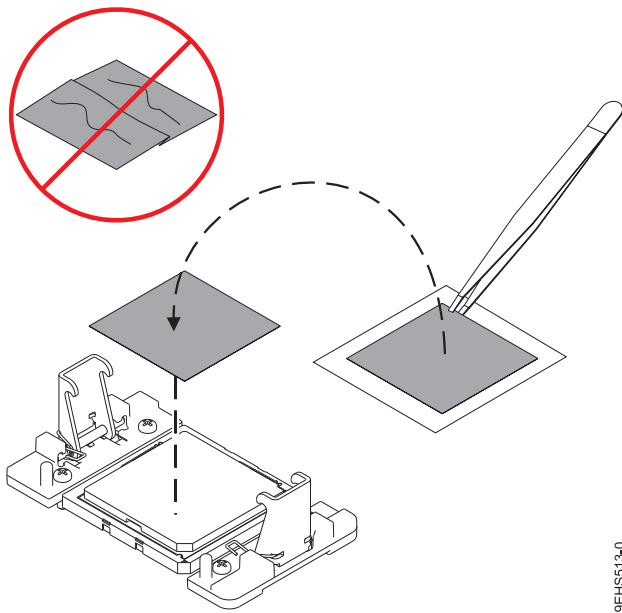
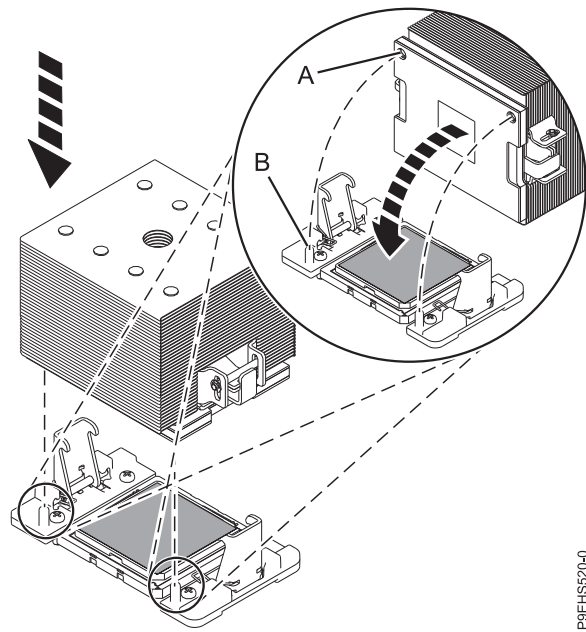

Figure 34. Installing a new TIM onto the processor



P9EHS513-0

P9EHS520-0

Figure 35. Installing the heat sink on the gray-colored TIM

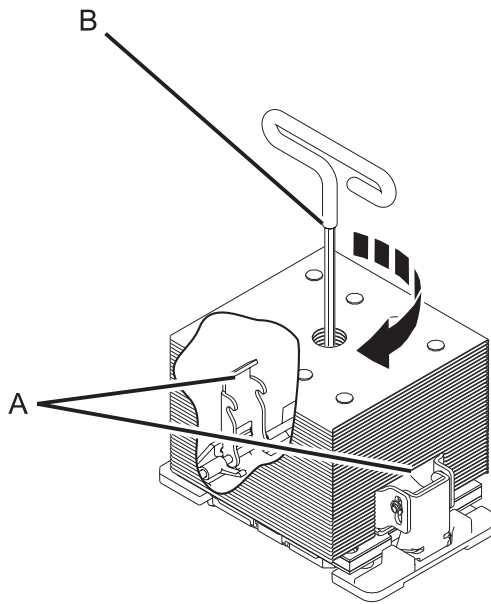

P9EHS507-0

Figure 36. Tightening the center load screw on the heat sink

---

This November 13, 2017 edition applies to IBM Power Systems servers that contain the POWER8 processor and to all associated models.

© Copyright IBM Corporation 2017.

US Government Users Restricted Rights – Use, duplication or disclosure restricted by GSA ADP Schedule Contract with IBM Corp.