

Save your budget. Save space. Save the planet.
Point-of-sale solutions that slash costs, optimize checkout space, and drive operational excellence and “green” initiatives



IBM SurePOS 300 Express Solution



“The SurePOS 300 Express offers small and mid-sized retailers the same advanced POS technology employed by retail giants—at the lowest price ever—to deliver quick ROI.”

Small and mid-sized retailers are faced with an uphill battle in today's fragmented, fiercely competitive market. They struggle to stay afloat in a world of retail giants with wide resources. IBM understands these demands and offers the innovative IBM SurePOS 300 Express at its lowest price ever—lower than a PC cash drawer.¹ This highly efficient performer with retail systems management is designed to transform your store operations, delivering fast ROI. The solution is available exclusively through the worldwide network of authorized IBM Business Partners who are experienced and highly skilled in providing a high level of service for IBM products, customized software and technical support to retailers.

The SurePOS 300 Express is the cost-saving, energy-efficient, compact POS solution

Saving your budget with a profit friendly, cost-effective solution, the IBM SurePOS 300 Express optimizes your POS investment and lowers total cost of ownership. It offers retail-hardened design for extended service life and is built on open standards for POS application and operating system choice. Existing peripherals can be employed and new ones added to adapt to future business needs. The solution is also easy to manage and service with IBM Retail Systems Management that helps monitor environmental variables and enables proactive maintenance. Easy tool-free access to the hard drive and power supply result in higher uptime and reduced IT service costs.

Overview

- **Objective**
Cut costs and increase profits by optimizing operations and delivering exceptional customer service
- **Solution**
IBM SurePOS™ 300 Express™
- **Benefits**
Less is more... less cost—greater value and affordability, less energy—efficient, low volt processor and deep sleep automation, less space—our smallest footprint

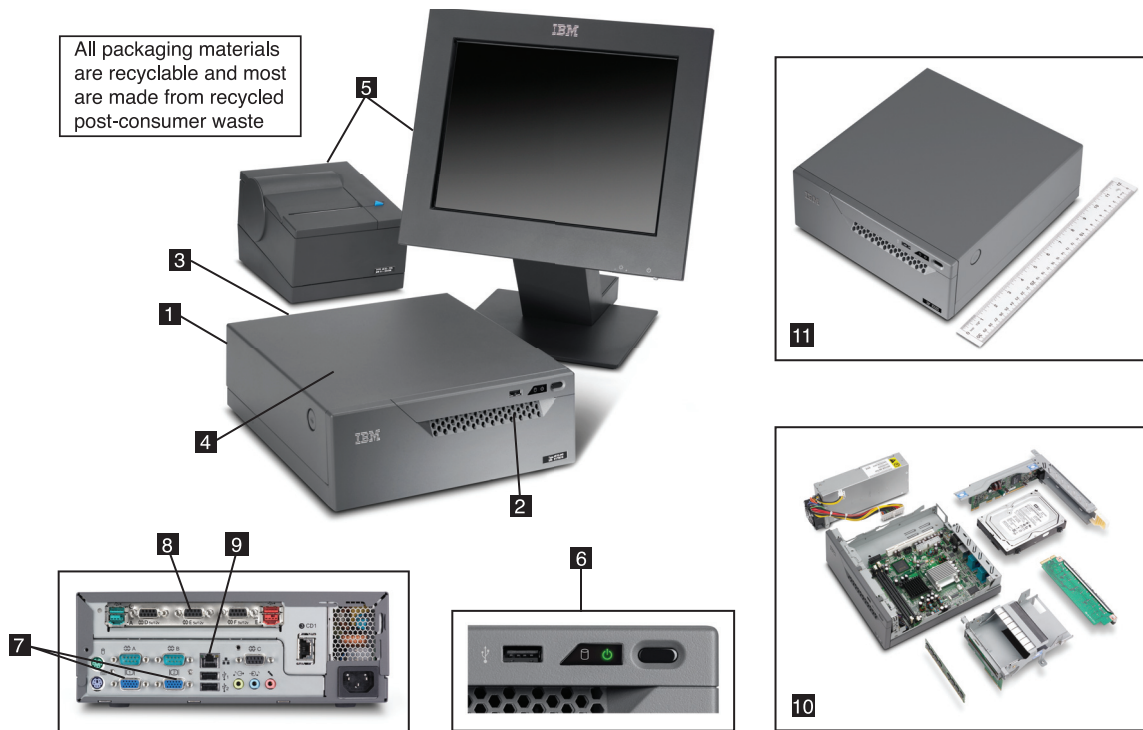

All packaging materials are recyclable and most are made from recycled post-consumer waste

IBM SurePOS™ 300 system with optional IBM modular CANPOS (Compact AlphaNumeric Point-Of-Sale) keyboard, IBM SureMark™ single station printer, IBM SurePoint™ 12" display

- | | | |
|--------------------------------------------------------------------------------------------------------------------------------------------------------------------------------------------------------------------------------------------------------------------------------------------------------------------------------------------------------------------------------------------------------------------------------------------------------------------|-------------------------------------------------------------------------------------------------------------------------------------------------------------------------------------------------------------------------------------------------------------------------------------------------------|---------------------------------------------------------------------------------------------------------------------------------------------------------------------------------------------------------------------------------------------------------------------------------------------------------------------------------------------------------------------------------------|
| <p>1. Ultra low volt Intel Celeron M 373 processor provides energy-efficient performance</p> <p>2. Front and rear vents provide better airflow and allow passive cooling</p> <p>3. Built-in power management including support of deep sleep automation to help minimize energy consumption</p> <p>4. Remote management enables monitoring of environmental variable for proactive servicing and maintenance to eliminate downtime</p> | <p>5. Color matched peripherals include the IBM SurePoint Solution, IBM SureMark printer, and modular keyboards (all optional)</p> <p>6. Front access to USB port for easy device attachment</p> <p>7. Dual video display capability delivers a superior customer experience</p> | <p>8. Selectable and upgradeable SurePorts enable retailers to use existing devices and connect customer or employee devices</p> <p>9. Ethernet 10/100 connectivity for fast Internet and store communications</p> <p>10. Tool-free access to key components helps reduce service time and cost</p> <p>11. 37% smaller footprint than previous models</p> |
|--------------------------------------------------------------------------------------------------------------------------------------------------------------------------------------------------------------------------------------------------------------------------------------------------------------------------------------------------------------------------------------------------------------------------------------------------------------------|-------------------------------------------------------------------------------------------------------------------------------------------------------------------------------------------------------------------------------------------------------------------------------------------------------|---------------------------------------------------------------------------------------------------------------------------------------------------------------------------------------------------------------------------------------------------------------------------------------------------------------------------------------------------------------------------------------|

World-class support

Authorized IBM Business Partners deliver the customized software and services that small and midsized businesses need.

IBM Financing Advantage

IBM Financing Advantage is a smart, simple and complete way to acquire IBM SurePOS Express Solutions. It gives you the control and flexibility you need with an array of financing and leasing options, allowing you to conserve cash, potentially lower your total cost of ownership and help grow your business.

Delivering energy efficiency, space saving and versatility,

the IBM SurePOS 300 Express is the affordable, planet-friendly point-of-sale solution designed to enhance the customer experience, increase employee productivity and improve operational efficiency. The space-saving solution provides the reliability and performance retailers need to compete. It speeds checkout to promote customer satisfaction and foster customer loyalty. It reduces complexity to allow retailers to manage more competitively and improve employee performance while employing breakthrough energy-efficient

technology to lower costs and move toward a more sustainable “green” operation.

Empowering your store with critical, on-target data,

the IBM SurePOS 300 Express delivers the valuable information you need to maintain a successful operation. Unlike a PC cash drawer or electronic cash register, this advanced POS helps drive business, enabling retailers to collect valuable information with each transaction. POS data can be used for monitoring daily financial returns, inventory management, merchandise planning, supply chain management and loyalty programs. And an IBM POS performs at a lower cost per customer than a PCCD due to faster, more accurate service.¹ It's the same advanced technology employed by global retail brands, engineered and priced for the smaller retailer.

Helping save the environment with breakthrough energy-efficient technology,

retailers are able to reduce costs from the substantial energy savings by employing “green” technology. A new, highly efficient power supply and ultra low volt Intel Celeron mobile processor save 35 percent on energy.

Plus IBM's innovative deep sleep⁴ mode can save another 47 percent of energy...reducing utility costs. This earth-friendly technology saves energy, lowers heat, reduces noise and increases reliability. The IBM SurePOS 300 Express also employs recyclable packaging to help cut waste disposal and meets strict worldwide environmental directives and product end-of-life requirements to restrict hazardous materials.

Offering a small footprint with big performance,

less is more with the IBM SurePOS 300 Express ... less space, less energy and less cost. Our smallest POS is now 37% smaller—measuring just over 10 in. (257 mm) in length, saving an actual \$84 in valuable checkout counter space.⁵ This amazingly small footprint offers flexible space-saving placement and remarkable versatility. The small footprint and distributed components also allow for ideal placement to enhance your store image.

For more information

To learn more about how the IBM SurePOS 300 Express and other IBM SurePOS solutions can save you money and keep your business competitive, contact your local IBM Business Partner, or visit ibm.com/products/retail.



Solution components (bundle shown is for North America only)

IBM SurePOS 300

- Intel ULV Celeron M 373 1.0 GHz² processor
- 160 GB³ hard drive
- Microsoft Windows Embedded for Point of Service V1.1 upgrade preloaded
- 512 MB DDR2 memory
- Front USB port to attach CD, DVD or floppy disk
- Replaceable SurePorts for new customer or employee devices when needed

IBM SureMark Printer

- Available with an optional impact station for multipart forms and checks

Optional upgrade features include:

- IBM Modular keyboards—compact, full-size, or 67-key
- IBM SurePoint displays
- IBM compact or full-size cash drawers
- Memory upgrades

Shown: IBM SurePOS 300, IBM modular CANPOS keyboard, IBM SureMark single station printer, IBM SurePoint 12" display.

- ¹ Research shows that a POS solution costs less over the first year of operation than a PC cash drawer solution. In addition, POS consistently delivers benefits for up to 70% longer than PCCD, and the cost advantage for the POS is greater the longer it is in use. Over the life of the system, this cost leverage has a major impact on the bottom line. When ongoing costs are taken into account, POS is consistently more cost-effective over time (average 23% lower costs annually) over the service life of the POS, which, in fact, is years longer than PCCD. IDC: Total Cost of Ownership for Point-of-Sale and PC Cash Drawer Solutions: A Comparative Analysis of Retail Checkout Environments, 2008 Update.
- ² MHz/GHz only measures microprocessor internal clock speed; many factors affect application performance.
- ³ MB/GB equals one million/billion bytes when referring to storage capacity; accessibility may be less.
- ⁴ Deep sleep is defined as "suspend to RAM" (random access memory), meaning the power supply is in a reduced power mode.
- ⁵ HdL Companies: "2007 Retail Store Taxable Sales Estimates," Sales per gross square foot derived from a variety of similar stores.

© Copyright IBM Corporation 2009

All Rights Reserved
IBM Corporation
PO Box 12195
3039 Cornwallis Road
Research Triangle Park, NC 27709

Printed in the United States of America
January 2009

References in this publication to IBM products or services do not imply that IBM intends to make them available in all countries in which IBM operates. Copying or downloading the images contained in this document is expressly prohibited without the written consent of IBM.

IBM, the IBM logo, ibm.com, Express, SurePoint, SurePOS and SureMark are trademarks of International Business Machines Corporation in the United States, other countries, or both. Other company, product and service names may be trademarks or service marks of others.

Intel, Intel logo and Celeron are trademarks or registered trademarks of Intel Corporation or its subsidiaries in the United States and other countries.

Microsoft and Windows are trademarks or registered trademarks of Microsoft group of companies.

Other company, product, or service names may be trademarks or service marks of others.

The IBM home page on the Internet can be found at ibm.com. For a copy of warranty terms and conditions, please contact IBM.



Recyclable, please recycle

RTS03013-USEN-00