

CATIA V5 Quick Surface Reconstruction

Automatic Surface Reconstruction

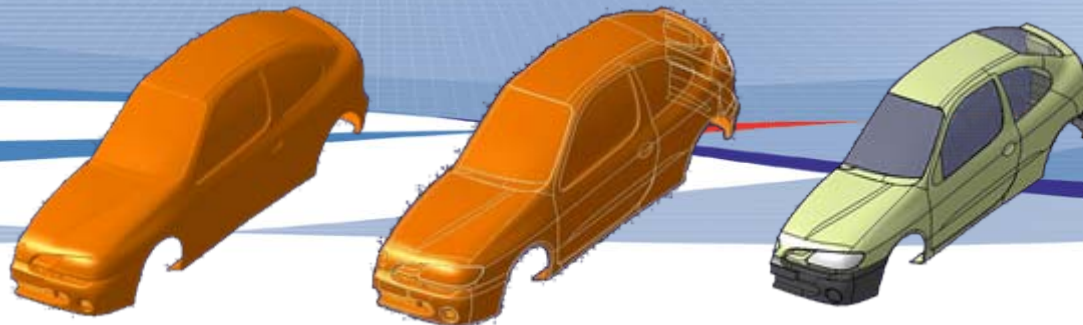
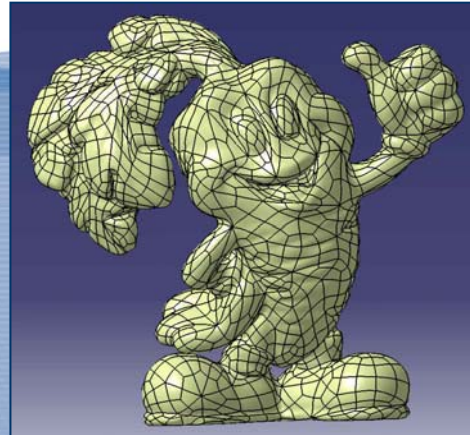

Rose-Marie Estebe
Dassault Systèmes Provence
ree@ds-fr.com

From Mesh to Surface : Automatic Reconstruction

■ CATIA V5 Quick Surface Reconstruction (QSR) :

- New command “Automatic Surface”

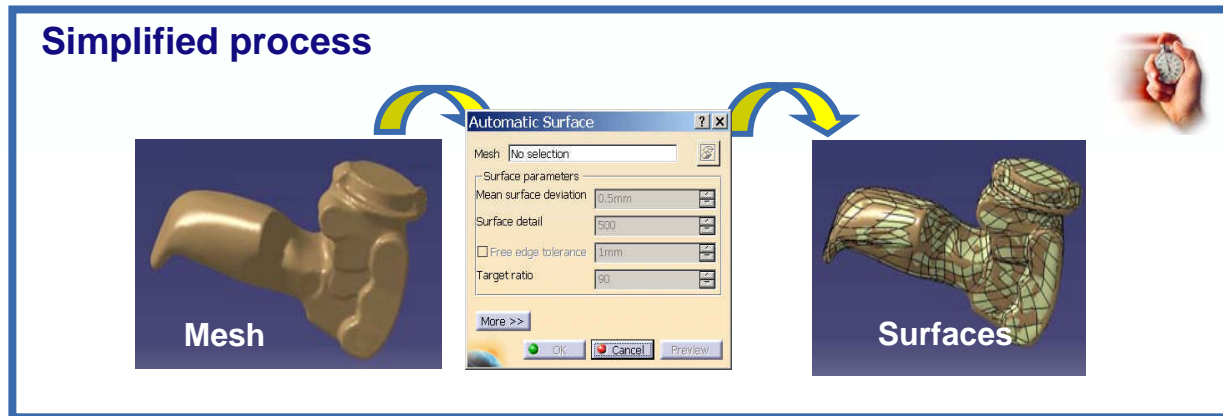

Value :

- **Productivity increase : “one click”**
- **New converter : “Digitized data (or STL data) to surface”**
Collaboration : allows to exchange very quickly accurate Data, reverse-engineered from a physical model
- **Ease of use for a non surface specialist**
- **Quality : perfect boundary continuity (tangency)**

Automatic Surface : Result on complex shape in about 1 mn

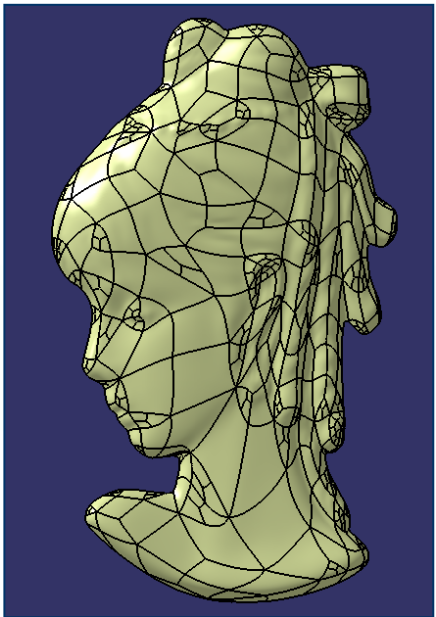
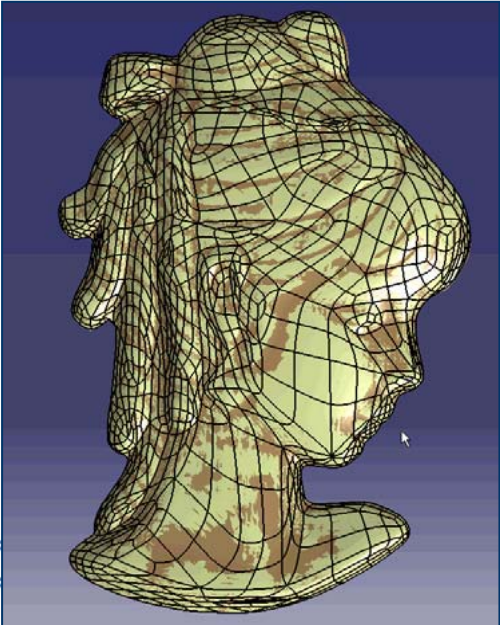
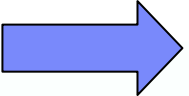
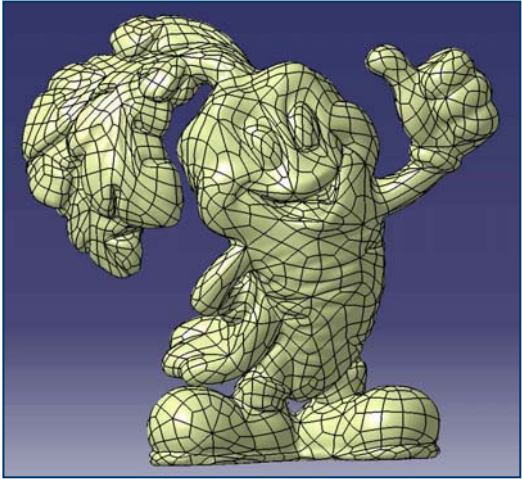
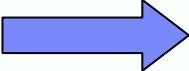

Automatic Surface : Result on mechanical shape in about 1 mn



Master model

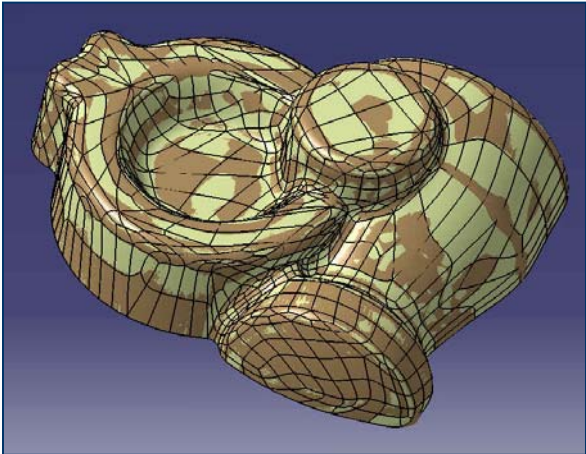

CAD Surfaces

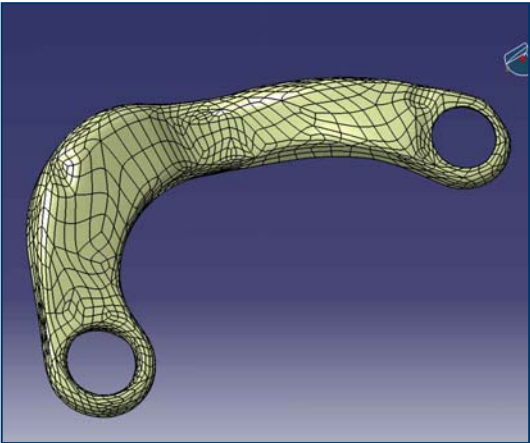

FE
Analysis or simulation

Let us Have a Closer Look ...

Demonstration : From Mesh to Surface



Thank You !

